



JMT

STRONG ON SERVICE

AD-SERVO HYBRID PRESS BRAKES



**It's difficult to compete in today's
world with yesterday's technology.**

We have solutions.



JMTUSA.com

Email: **JMT@JMTUSA.com**

Toll Free: **855-773-7727**
(855-PRESS-BRAKE)

JMT machines are built by the largest volume press brake producer and the most respected manufacturer of sheet metal machinery in the world. This factory is one of the world's most contemporary production plants, with a 1.5 million square foot footprint and over 1500 dedicated employees.

JMT machines are built to extremely stringent standards and the factory has maintained continuous product research and development since 1956. With 75 R&D and product engineers on-staff at the plant, **JMT** products utilize the most modern techniques in design and engineering, and are equipped with proven quality components to fulfill a customer's most exacting requirements. **JMT** combines "accuracy, speed, flexibility, durability, reliability and advanced technology" with the highest performance/price ratio in the world.

A nationwide network of **JMT** distributors and technical support personnel are in place to assist you.

Our machines are built with world-renown components such as Rexroth, Siemens and Schneider, which are available off the shelf from your local supplier, your dealer, or direct from **JMT**.

For more information please visit **JMTUSA.com**.

You can also email us at **JMT@JMTUSA.com** or call toll free to **855-773-7727** (855-PRESS-BRAKE).



MACHINE PARTS INVENTORY



JMT's U.S. HEADQUARTERS



PLANTS BUILDING OUR JMT MACHINES

JMT Press Brakes

JMT press brakes guarantee precision, low maintenance costs, low operating costs, and long-term reliability. These features, along with large investments in modern manufacturing equipment, have made the factory the largest volume press brake producer in the world.

All **JMT** press brakes are produced with modern design technology and incorporate rigid stress relieved frames to increase your productivity with accurate part production. Demanding application requirements are easily met. **JMT** press brakes come in a broad range of sizes with features to satisfy nearly all budgets.

JMT AD-R Series Press Brakes

3-5 Axis CNC • 4'-20' Bending Lengths + Tandem • 66-660 Tons

These value-oriented press brakes have exceptionally large strokes, daylights, and throat depths to allow cost effective production of simple to complex shapes that require large dimensions for ease of handling and removal. An easy-to-use control reduces the required operator skill level.



JMT AD-S Series Press Brakes

5-14+ Axis CNC • 6'-30' Lengths + Tandem/Trio/Quad • 66-4000 Tons

The possibilities are unlimited with these popular press brakes that feature faster setups and part production as well as large daylight opening and working areas.

Features include a stable and fast AC servo motor-driven back gauge system; a powerful, yet simple, 3D graphical viewing controller (standard); automatic CNC table crowning; and outboard-mounted long ram guides (which provide stability while allowing full length between the frames for acute angle bending).



JMT AD-SERVO Hybrid Series Press Brakes

5-14+ Axis CNC • 8'-10' Bending Lengths • 110, 150, 195 Tons

These eco-friendly hybrid press brakes provide fast, quiet, clean, accurate bending operations at a lower cost in an energy-efficient press brake design.

Like the AD-S, the AD-SERVO features a stable and fast AC servo motor-driven back gauge system; a powerful, yet simple, 3D graphical viewing controller (standard); automatic CNC table crowning; and outboard-mounted long ram guides (which provide stability while allowing full length between the frames for acute angle bending).



JMT FBS Press Brakes (Flexible Bending Solutions)

JMT provides the latest technology in "large format" bending and automation with their "Flexible Bending Solutions." This advanced technology allows diversified uses in different industries while avoiding long, expensive welding operations (which also risk the stability of the material).

Features include reduced material handling, compensation for high spring-back sheets, reduced setup times through automated loading and unloading as well as increased employee safety.

The higher tonnage press brakes utilize a unique "box construction" design which provides the most stable machine frame in the industry.



***JMT* AD-SERVO HYBRID SERIES**

- **5-14+ Axis CNC**
- **110, 150, 195 Tons**
- **8'-10' Bending Lengths**
- Increase your competitive forces by 62% lower power consumption
- Lower cost per part by ecological technology
- Quiet, energy efficient and accurate
- Ram movement is powered by AC Servo motors driving hydraulic oil in line with variable speed pump.

New technology allows :

- Silent bending
 - Noise level reduced to 63 dbA from 76 dbA
- Energy saving
 - 62% at stand-by
 - 44% during the press cycle
 - 60% in 1 hour with 15 press cycles
- Supports your production cost efficiency and increases your competitive forces.
- Small hydraulic oil tank for clean environment and cost reduction
 - New technology reduces hydraulic tank from 60 gallons to 2 x 10 gallons
- Speed and accuracy and synchronization
 - Beam speeds to 472" per minute (higher with optional safety laser guarding)
 - 5.6 times better synchronization in high speed mode (Y1/Y2)



JMT AD-SERVO PRESS BRAKE STANDARD EQUIPMENT

JMT AD-SERVO Hybrid Series press brakes are manufactured with exceptionally large stroke/daylight combinations as well as high speed ram and back gauge positioning. The production of deep boxes and other parts requiring large clearances are produced with ease. The AD-SERVO Series is truly a machine for fast and accurate production of precision parts; simple, complex, large or small.

- 5 axis CNC:
 - Y1, Y2 precision ram positioning (twin electro/hydraulic drive)*
 - X, R precision servo-driven back gauge
 - CNC motorized wave crowning
- Large trio of value:
 - Large open height
 - Large stroke
 - Large throat depth
- Delem DA-66T touch screen CNC control unit with 3D graphical visualization (see *optional controls below*)
- American/European section-style box punch clamps
- Standard X-axis travel is 25.6" with third gauge step capable of gauging parts up to 39" with standard back gauge (most machines)
- Stable and fast AC servo motor-driven precision back gauge with linear guide and ball bearing system (X - R)
- Quick-set sliding front sheet support arms with full-length linear guide, tilting stop and T-slot (front gauging squaring, etc.)
- Protection covers (side and rear safety doors)
- Rear work light
- Specially-designed electro-hydraulic operation (Rexroth)
- World-class electronics system (common, off-the-shelf components)
- High-yield plate construction
- Ability to accurately fade ram
- Stage bending
- Automatic bend sequence determination
- Automatic stretch length calculator for blank size determination



- * Two direct-acting servo motors for ram positioning where each cylinder operates independently in a closed loop system. Linear encoders are mounted on a separate sub-frame on each side of the machine. These encoders combined with precision servo-hydraulic valves and the CNC command center, provide accuracy of \pm one Micron (0.00004") and the ability to program all ram positions, ram speeds and ram tilt. The decompression point is also programmable, which, along with programmable speeds is very useful when bending large sheets or high-yield material.

JMT AD-SERVO PRESS BRAKE OPTIONAL EQUIPMENT

- Safety laser: AKAS-LC manual or motorized
- Light curtain: SICK C 4000 for tandem/trio/quad machines
- Robotics
- Adaptive bending sensors
- Multiple axes available:
 - Z1, Z2 Axes
 - X1, X2 Axes
 - R1, R2 Axes
 - Delta X axis, +/- 5" stroke (10" total)
 - X Axis = 39.4" travel - Back protection with light barrier
 - AP3-AP4 Sheet follower with sliding guide - motorized height adjustment
- Other CNC control units available:
 - Delem DA-69T touch screen 2D/3D CNC control
 - Cybelec ModEva 10S/12S/15S 3D with PC 1200 3D SW
- Clamping:
 - Quick Release Clamping
 - JMT Hydraulic or Mechanical Clamping
 - Wila or Wilson Hydraulic or Mechanical Clamping
- Various tool options (JMT, Euro-American, Wila or Wilson)
- Bottom tool positioning system
- Thickness measurement systems
- Offline software (V-Bend, Profile-W)
- Tooling packages

Many options and customizations are available — please contact us for details.

Web: **JMTUSA.com**

Email: **JMT@JMTUSA.com**

Call Toll Free: **855-773-7727**
(855-PRESS-BRAKE)

JMT AD-SERVO PRESS BRAKE TECHNICAL DIMENSIONS

AD-SERVO Series		25100	30100	30135	30175
Bending Length [A]		8' 4"	10'	10'	10'
Bending Force		110 Tons	110 Tons	150 Tons	192 Tons
Distance between Frames [B]		7' 2"	8' 6"	8' 6"	8' 6"
Y-Axis Speeds	Y-Axis Rapid Speed (Inches per Minute)	473	473	473	425
	Y-Axis Working Speed (Inches per Minute)	24	24	24	24
	Y-Axis Return Speed (Inches per Minute)	473	473	425	378
	CNC Crowning <i>Standard</i>	Motorized	Motorized	Motorized	Motorized
Daylight [D]		20¾"	20¾"	20¾"	20¾"
Bed Cap Width [G]		4"	4"	4"	4"
Bed Height [F]		35½"	35½"	35½"	35½"
Depth of Pit		—	—	—	—
Stroke [C]		10½"	10½"	10½"	10½"
Throat Depth [E]		16"	16"	16"	16"
Sliding Support Arms (Quantity)		2	2	2	2
Back Gauge Finger Blocks (Quantity)		2	2	2	2
Gauging Axes <i>Standard</i>	Speed of Travel in X-Axis (Inches per Minute)	1200	1200	1200	1200
	Travel in X-Axis	25½"	25½"	25½"	25½"
	Gaugable with 3rd Position	39.6"	39.6"	39.6"	39.6"
	Speed of R-Axis (Maximum Inches per Minute)	826	826	826	826
	Travel in R-Axis	10"	10"	10"	10"
Motor Power		2 x 28 HP	2 x 28 HP	2 x 30 HP	2 x 40 HP
Oil Tank Capacity		21 Gallons	21 Gallons	21 Gallons	31 Gallons
Overall Dimensions	Length [L]	12' 6"	13' 10"	13' 10"	14'
	Width [W]	5' 6"	5' 6"	5' 7"	5' 7"
	Height [H]	9'	9'	9'	9'
	Weight (Approx.)	19,625 Lbs.	20,945 Lbs.	23,150 Lbs.	25,355 Lbs.

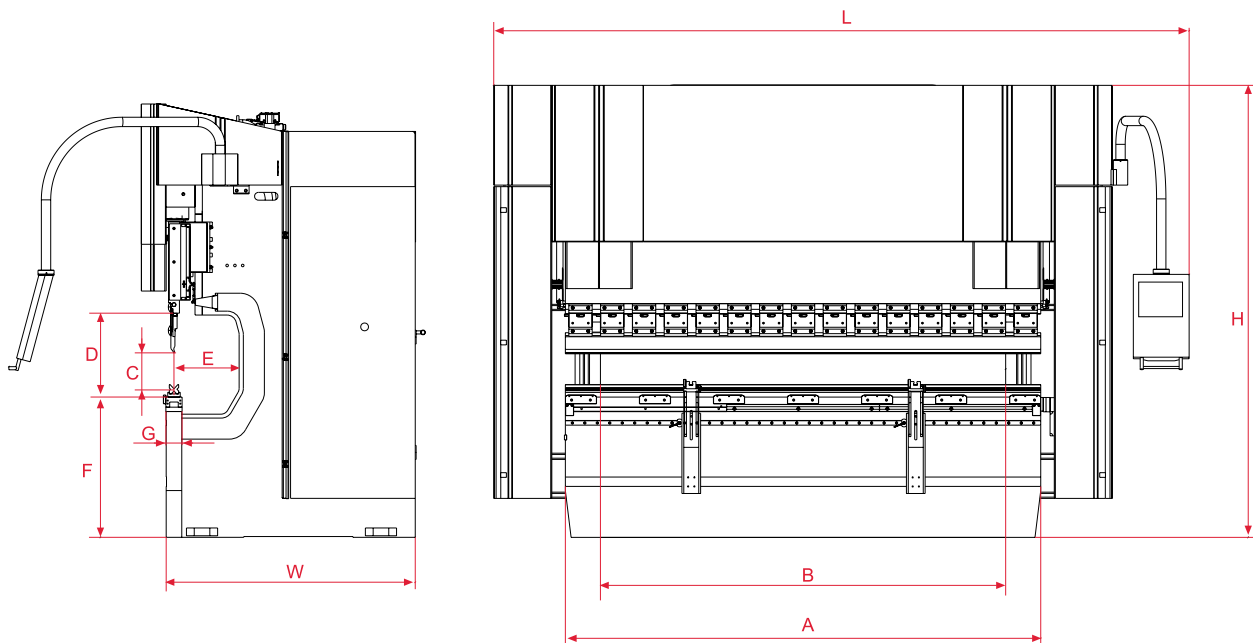

The above are standard specifications.* Please contact us for other sizes and options.

**Due to ongoing product development, specifications are subject to change.*



JMTUSA.com

Email: **JMT@JMTUSA.com**

Toll Free: **855-773-7727**
(855-PRESS-BRAKE)

