

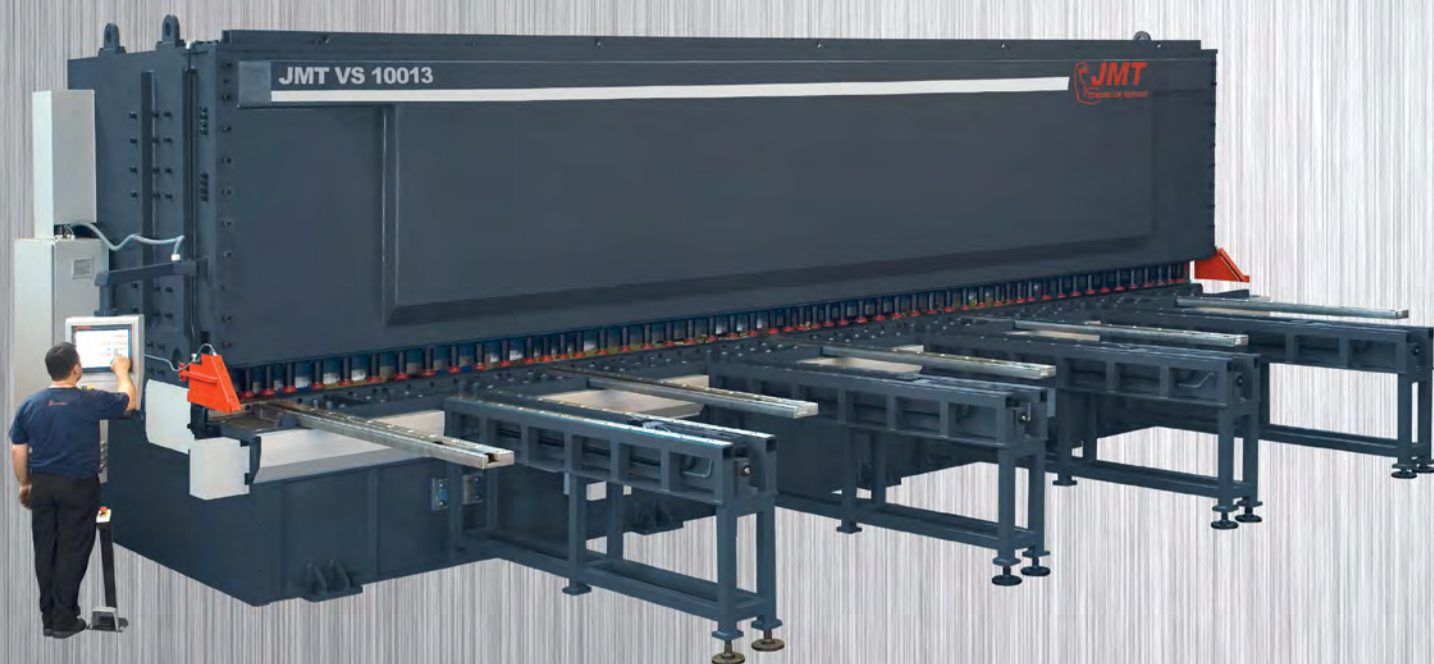

SHEARS



**JMT offers quality machine tools
for all your sheet metal fabrication needs.**



JMTUSA.com

Email: JMT@JMTUSA.com

Toll Free: **855-773-7727** (855-PRESS-BRAKE)

JMT sells and services quality metal fabrication machine tools for a wide range of sheet metal and structural steel working applications that include bending, rolling, cutting, drilling, positioning, punching, shearing and welding.

JMT, a division of Jorgenson Industrial Companies, is a family owned business established in 1967. Roger Jorgenson made it his mission to build this company on the foundation of strong customer service. His children now continue this tradition since assuming leadership of the company in 2008 and establishing the **JMT** brand.

JMT is supported by an ever expanding team of industry professionals, which include experienced application engineers, sales consultants and veteran service engineers. **JMT** also has a resourceful parts and tooling department to keep your machines working at optimal performance.

The company has a 30,000 square foot showroom, warehouse and service center at its headquarters in Salt Lake City, Utah. **JMT** also has a warehouse and service center in Atlanta, Georgia.

A national network of over 30 select distributors trained to sell and service **JMT** machines are strategically located to provide the fastest response times to our customers.

JMT machines are built to our stringent set of design and quality standards in state-of-the-art manufacturing facilities. **JMT** partners with manufacturers that have extensive experience building machine tools for some of the leading suppliers in the industry.

JMT product designs combine accuracy, speed, flexibility, durability, reliability and advanced technology to deliver machines with the highest performance-to-price ratio in the industry.

For more information please visit www.JMTUSA.com
or call toll free **855-773-7727** (855-PRESS-BRAKE).
or email us at JMT@JMTUSA.com.



**SOME OF THE FABRICATION
EQUIPMENT OFFERED BY JMT**



The machinery showroom at **JMT's** corporate headquarters.

JMT Shears

Our shears are durable, low distortion, precise cutting machines and are installed and working in a wide variety of sheet metal cutting operations across many industries.

Even large shear frames are machined with no repositioning, resulting in parallel and square surfaces.

Automatic adjustment of the hold-down pressure on our hydraulic shears firmly secures thick or thin sheets prior to the actual cutting.

JMT VS Series Shears

Variable Rake Touch Screen CNC Shear

1/4" – 1" Capacities

10' – 30' Lengths

Cutting angle and blade gap are adjusted automatically via the CNC for flexible and precise cutting process



JMT SBT Series Shears

Swing Beam Touch Screen CNC Shear

1/4" – 3/4" Capacities

10' – 13' Lengths

Heavy duty, robust swing beam cutting with optimized cutting parameters



JMT MS Series Shears

Mechanical High Speed Shear

12 Gauge – 10 Gauge Capacities

4' – 10' Lengths

All-in-one: High Speed, Accurate, Efficient, Performance



***JMT* VS SERIES SHEAR**

Variable Rake CNC Shear

- **1/4" – 1" Capacities**
- **10' – 30' Lengths**
- Solid design and durable body for precise cutting results
- Blade clearance, cut length and cutting angle are automatically adjusted by the CNC control
- User-friendly CNC touchscreen control unit
- Flexibility for thin/thick, narrow/wide sheets
- For more sophisticated use, the following can be easily integrated:
 - Automatic swing-up back gauge
 - Sheet support systems
 - Return to sender
 - Automatic feeding and conveyor systems
- For sheet handling and ease of operation, standard T-slotted sheet support arms and tabletop ball transfers make sheet feeding easy
- Fast cycle times for thick or thin sheets



JMT VS SERIES SHEAR FEATURES



Finger Guard, Ball Transfers and Hold Downs

The first 39" of the finger guard can be flipped up out of the way for easy viewing of the work piece. Hold downs are provided to ensure that the plate is held firmly along the length of the cutting area. The hold downs are distributed closer at each end of the table. This guarantees not only safer operation at the beginning and end of the cut but also the accuracy for narrow (short) plates at each end of the machine. Each independently acting hold down is capable of applying high pressure to hold the material being cut at the same time preventing thin and delicate materials from being marred.



Back Gauge (Standard)

The back gauge adjustment, standard range 39.37", has play free straight guides and recirculating ball screws; it has speed of 472 IPM, a setting accuracy of 0.004" and a repetitive accuracy of ± 0.0004 " (by means of a closed loop control). A standard feature of the back gauge is clearance compensation and it retracts automatically when cutting narrow strips.

The back gauge can swing away at the end of its travel to allow the shearing of unlimited length drop pieces.

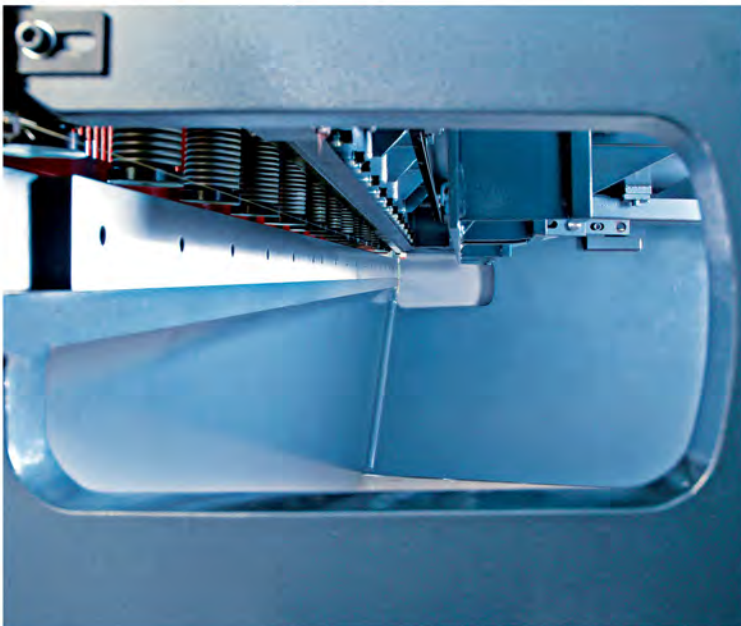

Throat Depth (Standard)

Throat depth (minimum 13.78") in the side frames allows shearing of sheets longer than the blade length.



Light Curtain for Finger Protection (Optional)

Simple, secure handling.

JMT VS Series Shear CNC Control Units



USB 2.0



D-Touch 7 CNC Touch Screen Control Unit

- Large Color Touch Screen, Lcd: 7", 800 X 480 Tft Lcd Display
- Rapid data input
- Easy communication, USB Port: Usb port for user usb flash memory
- Ethernet: RJ-45 10/100M
- Operating System: Windows CE
- User Program and Steps: Unlimited
- Material Type: Unlimited

JMT VS Series Shear Pneumatic Sheet Support Devices



JMT 1

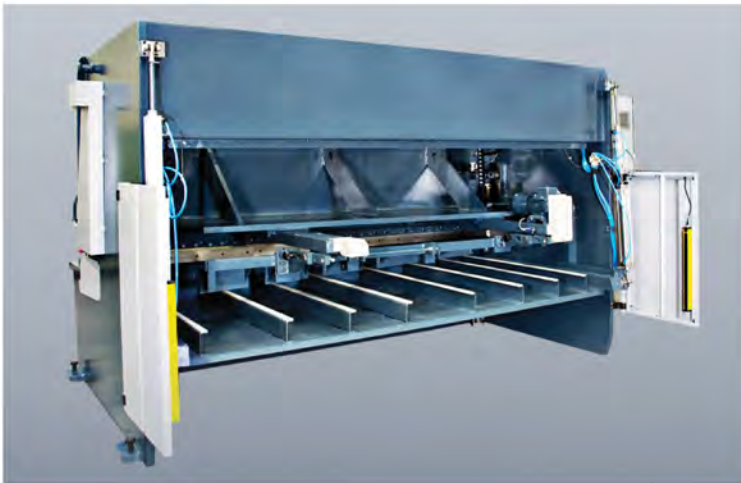
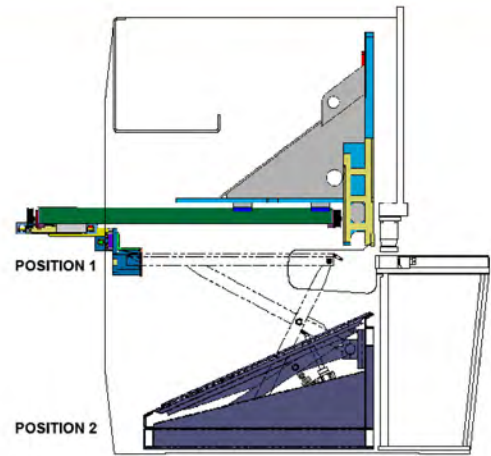

JMT 2

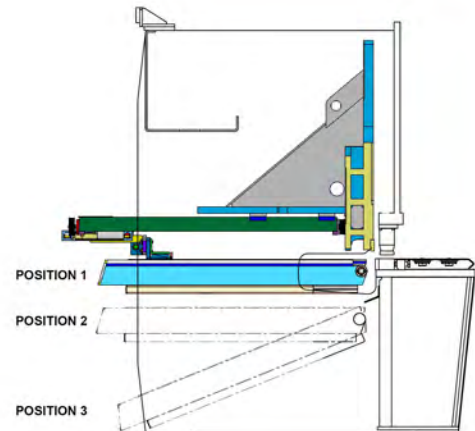

JMT 3

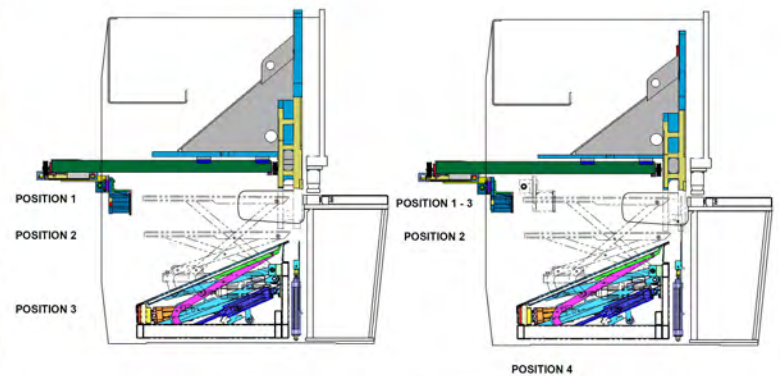

Anti twisting

Return to sender

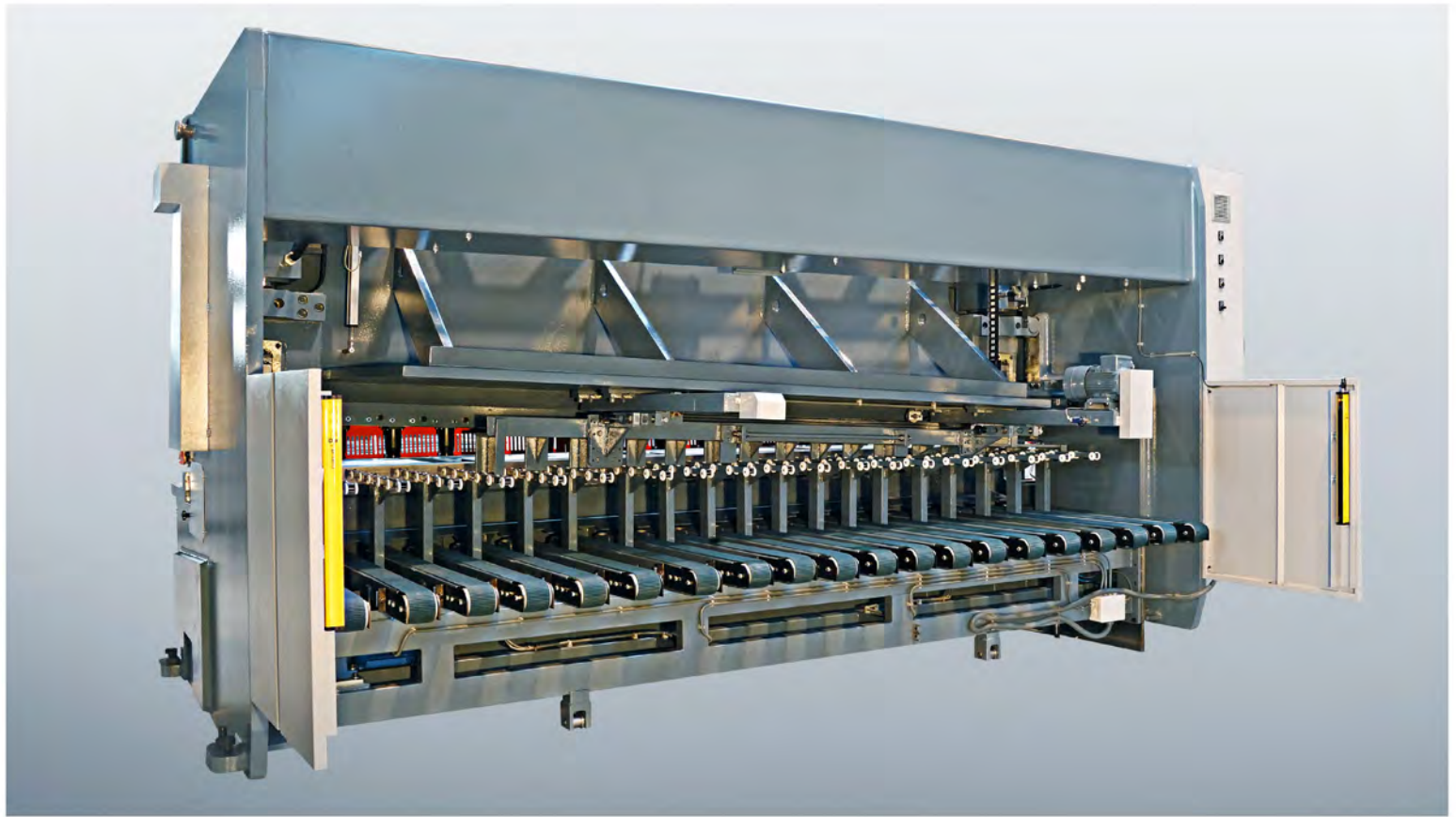

Sheet Support Devices with Conveyor and Scrap Container



Scrap + Stacker + Alignment System



Front Feeding System

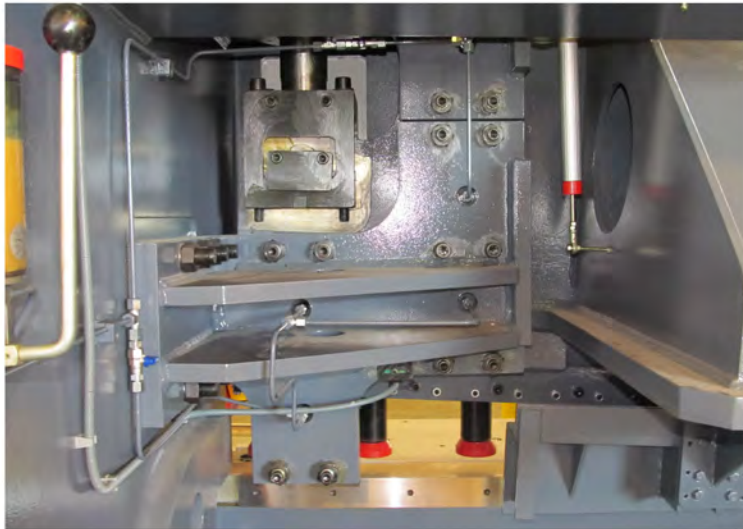

Heavy Machine Beam and Guides

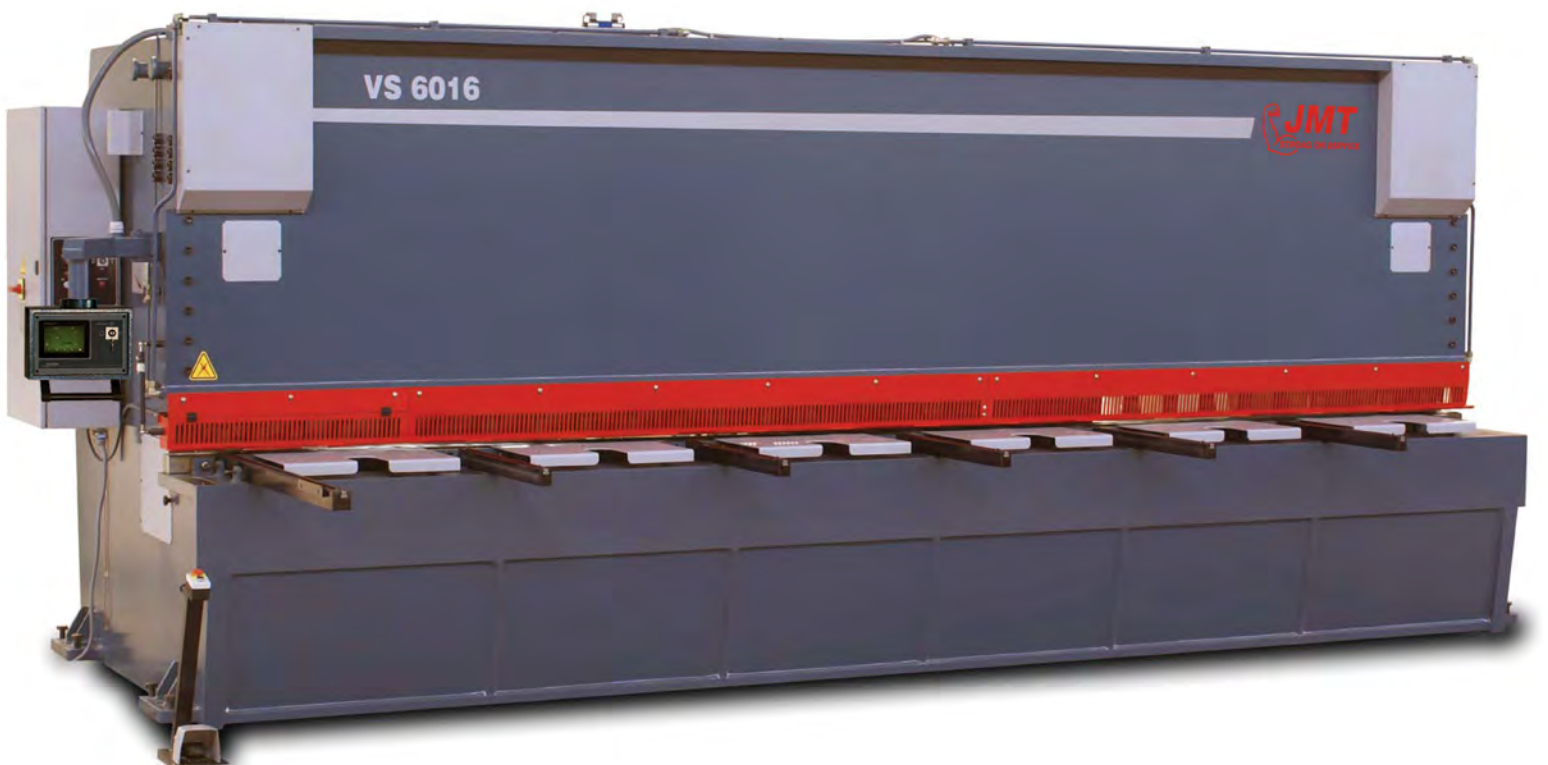

JMT VS SHEAR STANDARD EQUIPMENT

- High yield, heavy duty steel construction (St 44) and stress-relieved frame
- User-friendly CNC Touchscreen control unit (D-Touch 7)
- Automatically adjusted rake angle by CNC
- Automatically adjusted blade gap by CNC
- Automatically adjusted cutting length by CNC
- Ball integrated front tables
- 39" ballscrew back gauge
- 39" flip-up finger guards
- 59" squaring arm with scale, T-slot and tilting stop
- 39" support arms with T-slot and tilting stop
- Illumination and shadow line
- 13.8" throat depth
- Automatic pressure-adjusted solid hold-downs
- Top and bottom blades with four sides
- Foot pedal
- World standard electrical/hydraulic components (parts stocked by JMT or available off-the-shelf from your local supplier)
- Heavy guillotine design

JMT VS SHEAR OPTIONAL EQUIPMENT

- High speed (stroke per minute)
- Laser cutting line
- Light curtains for finger protection
- Pneumatic sheet support device: "Standard" (JMT I)
- Pneumatic sheet support device: "Two Steps" (JMT II)
- Pneumatic sheet support device with "Return to Sender" (JMT III)
- Sheet support device with conveyor belt and scrap container
- Stacker + alignment cylinder
- CNC front feeding system
- Hydraulic anti-twist device
- Special throat depth
- 49" back gauge
- X1, X2 axis (Taper)
- Hydraulic swing-up back gauge
- Oil coolant
- Central lubrication manual
- Central lubrication motorized
- Adjustable angle stop 0-180°
- Additional support arms
- Special blades
- Special color
- Control panel on opposite position
- Temperature measurement

Many options and customizations are available — please contact us for details.

Web: **JMTUSA.com**

Email: **JMT@JMTUSA.com**

Call Toll Free: **855-773-7727**
(855-PRESS-BRAKE)

JMT VS SHEAR TECHNICAL DIMENSIONS

VS SERIES	3006	3010	3013	3016	3020	4006	4013	4016	4020
Cutting Length [A]	10'2"	10'2"	10'2"	10'2"	10'2"	13'4"	13'4"	13'4"	13'4"
Cutting Capacity: Mild Steel	.250"	.375"	.500"	.625"	.750"	.250"	.500"	.625"	.750"
Cutting Capacity: High Tensile (105,000 PSI)	.157"	.315"	.375"	.500"	.625"	.157"	.315"	.375"	.375"
Strokes per Minute (Full Length, Max. Capacity)	12	10	9	7	6	10	7	5	4
Strokes per Minute (30% Length, Max. Capacity)	20	20	17	12	12	20	13	9	8
High Speed SPM (Full Length, Max. Capacity & Maximum Rake Angle)	21	15	15	11	9	19	13	10	8
High Speed SPM (30% Length, Max. Capacity & Maximum Rake Angle)	33	27	27	18	17	31	25	17	16
Cutting Angle (Minimum)	.5°	.5°	.5°	.5°	.5°	.5°	.5°	.5°	.5°
Cutting Angle (Maximum)	2°	2°	2.5°	2.5°	2.5°	2°	2.5°	2.5°	2.5°
Number of Holddowns	16	16	17	14	14	20	20	17	21
Holddown Force (Min. Ton)	4.4	4.4	8.8	12	18	4.4	11	55	55
Holddown Force (Max. Ton)	22	22	44	61	91	22	53	110	110
Back Gauge Travel	39"	39"	39"	39"	39"	39"	39"	39"	39"
Back Gauge Speed I.P.M	472	472	472	472	472	472	472	472	472
Motor Power	15	30	40	60	60	15	40	60	60
Oil Capacity (U.S. Gallons)	33	48	80	120	132	120	90	105	132
Throat Depth [D]	13.8"	13.8"	13.8"	13.8"	13.8"	13.8"	13.8"	13.8"	13.8"
Front Sheet Supports	3	3	3	3	3	4	4	4	4
Table Height [C]	32"	33"	33"	33"	33"	33"	33"	40"	40"
Table Width [B]	20"	20"	20"	20"	23"	20"	23"	25"	25"
Table Length [R]	129"	132"	133"	134"	136"	173"	173"	172"	174"
Length [L]	161"	161"	165"	163"	162"	203"	205"	232"	232"
Width [W1]	80"	80"	83"	87"	91"	82"	85"	83"	87"
Total Width (with Squaring Arm) [W]	140"	140"	140"	143"	146"	140"	140"	143"	148"
Height [H]	77"	85"	97"	101"	104"	80"	100"	116"	116"
Weight (Lbs.)	17,600	22,400	28,600	39,700	48,000	27,200	37,400	52,000	64,000

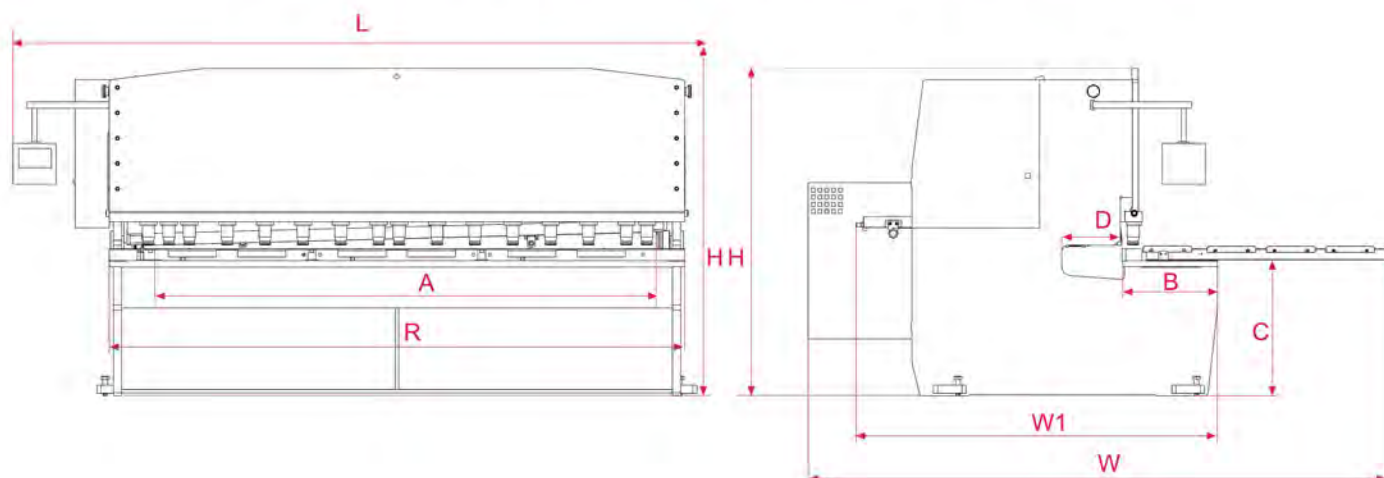

JMT VS SHEAR TECHNICAL DIMENSIONS (Continued)

VS SERIES	6006	6013	6016	6020	6025	80100	10013
Cutting Length [A]	20'	20'	20'	20'	20'	26'6"	33'1"
Cutting Capacity: Mild Steel	.250"	.500"	.625"	.750"	1"	.375"	.500"
Cutting Capacity: High Tensile (105,000 PSI)	.157"	.315"	0.375	.5"	.73"	.250"	.315"
Strokes per Minute (Full Length, Max. Capacity)	6	5	4	3	3	3	3
Strokes per Minute (30% Length, Max. Capacity)	10	10	10	6	6	6	6
High Speed SPM (Full Length, Max. Capacity & Maximum Rake Angle)	—	—	—	—	—	—	—
High Speed SPM (30% Length, Max. Capacity & Maximum Rake Angle)	—	—	—	—	—	—	—
Cutting Angle (Minimum)	.5°	.5°	.5°	.5°	.5°	.5°	.5°
Cutting Angle (Maximum)	2°	2.5°	2.5°	3°	3.5°	2°	2°
Number of Holddowns	29	29	29	29	30	40	52
Holddown Force (Min. Ton)	11	32	32	53	165	44	66
Holddown Force (Max. Ton)	22	65	65	110	275	66	90
Back Gauge Travel	39"	39"	39"	39"	39"	39"	60"
Back Gauge Speed I.P.M	472	472	472	472	472	472	472
Motor Power	30	50	60	60	75	40	60
Oil Capacity (U.S. Gallons)	53	106	145	185	200	145	170
Throat Depth [D]	13.8"	13.8"	13.8"	13.8"	13.8"	20"	30"
Front Sheet Supports	6	6	6	6	6	7	9
Table Height [C]	35"	37"	37"	40"	40"	48"	48"
Table Width [B]	25"	25"	25"	32"	36"	34"	34"
Table Length [R]	250"	250"	250"	260"	266"	336"	420"
Length [L]	287"	291"	291"	319"	310"	360"	452"
Width [W1]	85"	87"	87"	110"	115"	132"	134"
Total Width (with Squaring Arm) [W]	140"	146"	150"	162"	167"	165"	167"
Height [H]	108"	114"	114"	140"	134"	129"	150"
Weight (Lbs.)	56,000	75,000	85,000	136,000	165,000	193,000	328,000

The above are standard specifications.*
Please contact us for other sizes and options.

**Due to ongoing product development, specifications are subject to change.*

***JMT* SBT SERIES SHEAR**

Swing Beam Touch Shear

- **1/4" – 3/4" Capacities**
- **10' – 13' Lengths**
- World's heaviest and most robust swing beam shear construction
- Proven reliable design frame with rigid swing style upper beam
- Optimized cutting angle for minimized distortion
- Oversized roller bearing guides and box constructed swing beam for constant blade gap over full cutting length contribute to straight cuts
- Easy and low maintenance operation

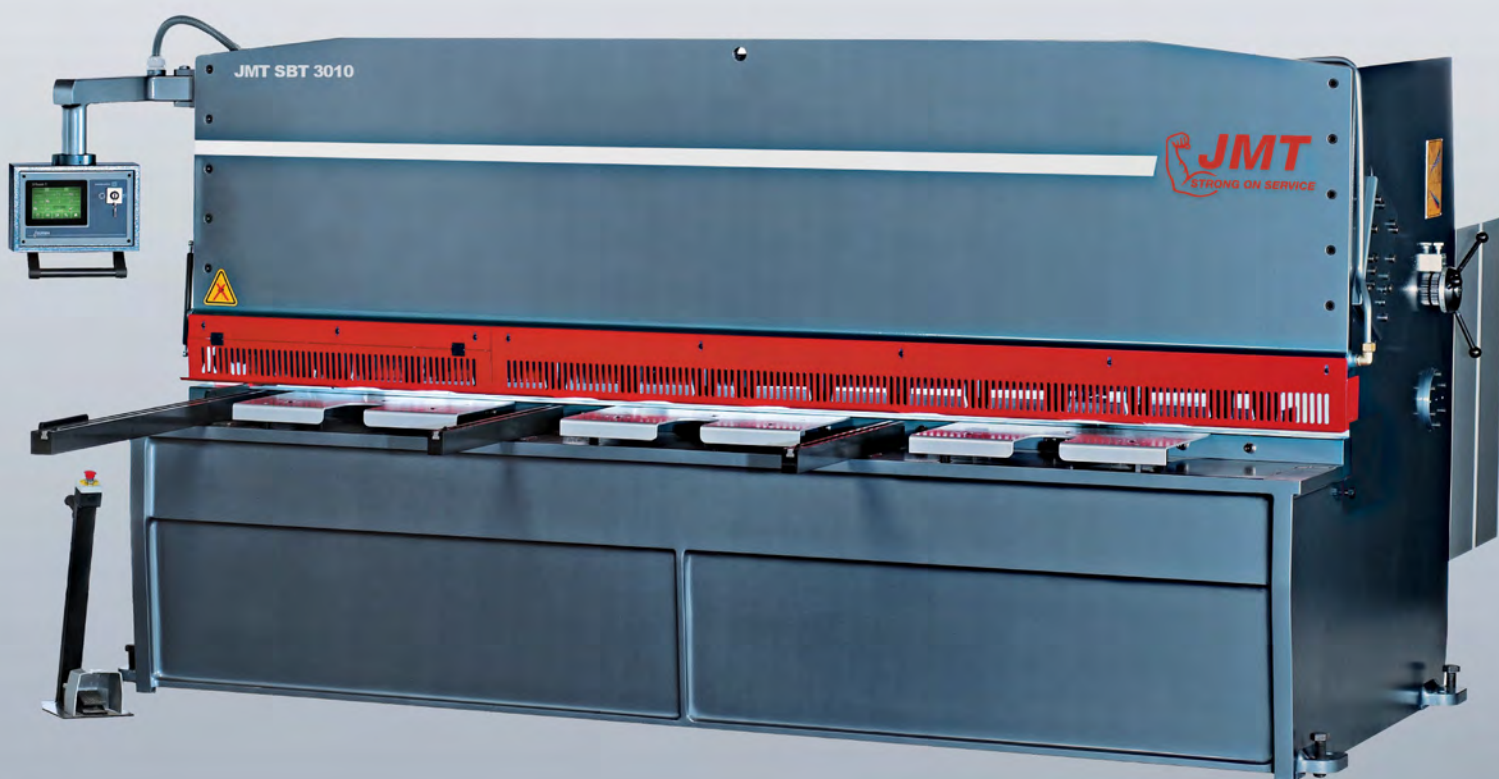

FEATURES



USB 2.0



D-Touch 7 CNC Touch Screen Control Unit

- Large Color Touch Screen, Lcd: 7", 800 X 480 Tft Lcd Display
- Rapid data input
- Easy communication, USB Port: Usb port for user usb flash memory
- Ethernet: RJ-45 10/100M
- Operating System: Windows CE
- User Program and Steps: Unlimited
- Material Type: Unlimited



Single Point Blade Clearance (Standard)

A quick-set single point blade gap adjustment is conveniently located on the side frame of the machine. The operator can easily and quickly change this setting, as the material type and thickness demands, for a high quality blank.

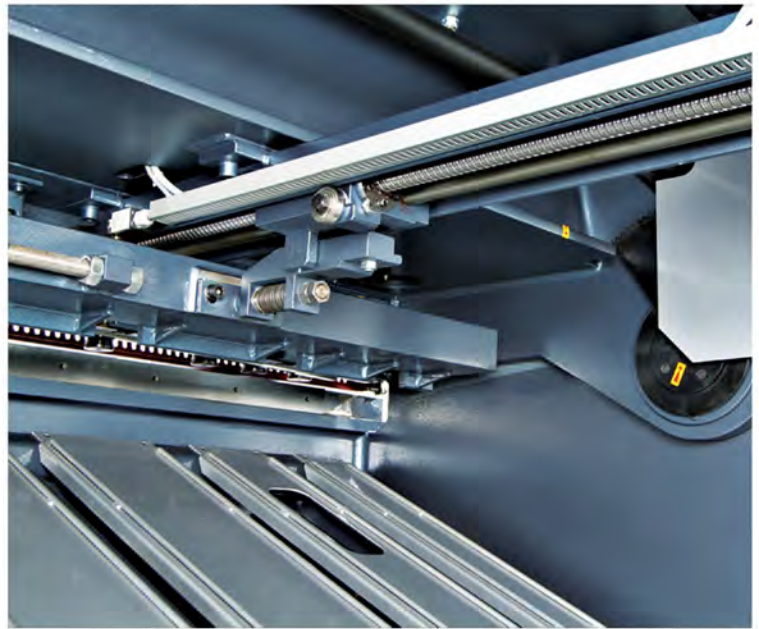

Swing Up Or Away Back Gauge (Standard)

Back gauge can swing away at the end of its travel to allow the shearing of unlimited length drop pieces. Also available is a swing up style, which swings up and out of the way when the back gauge reaches the end of its range. Both styles allow shearing sheets of an unlimited length.

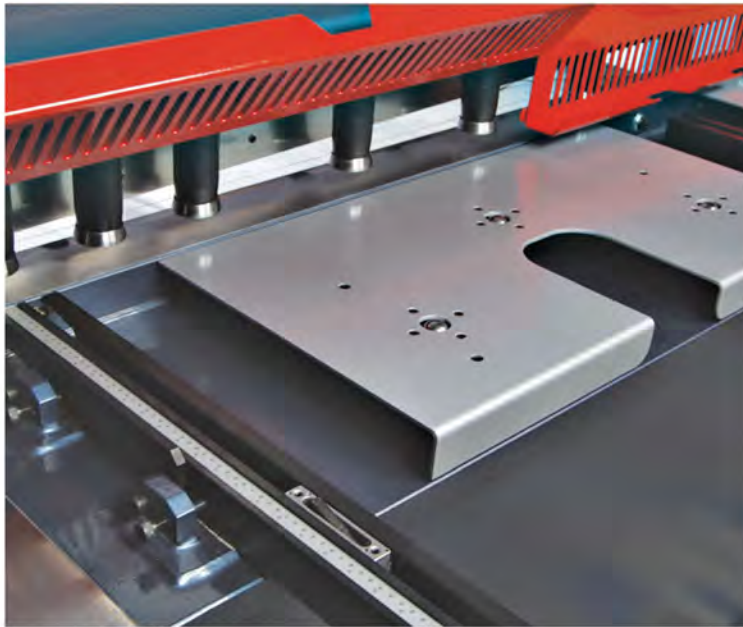

Finger Guard, Ball Transfers and Hold Downs

The first 39" of the finger guard can be flipped up out of the way for easy viewing of the work piece. Hold downs are provided to ensure that the plate is held firmly along the length of the cutting area. The hold downs are distributed in such a way that more are closer at each end of the table. This guarantees not only safer operation at the beginning and end of the cut but also the accuracy for narrow (short) plates at each end of the machine. Each independently acting hold down is capable of applying high pressure to hold the material being cut at the same time preventing thin and delicate materials from being marked.



Rear Sheet Support System (Optional)

When shearing long drop pieces of thin material the sheet can droop before it reaches the gauge bar, therefore making it impossible to gauge or, at least gauge accurately. In this system support arms which are pneumatically activated support the sheet while gauging and then automatically move away for shearing after the sheet is securely clamped and gauged. This also eliminates the need to front gauge and the need for the operator or additional personnel, to manually support the sheet from the rear side of the machine, which is not only costly, but unsafe.

JMT SBT SHEAR STANDARD EQUIPMENT

- High-yield, heavy duty steel construction (St 44) and stress-relieved frame
- User-friendly CNC Touchscreen control unit (D-Touch 7)
- Easy blade gap adjustment
- Ball integrated front tables
- 39" ballscrew back gauge with automatic swing-up
- 59" Squaring arm with scale, T-slot and tilting stop
- 39" support arms with T-slot and tilting stop
- Illumination and shadow line
- 39" flip-up finger guards
- Pressure-adjusted solid hold downs
- Foot pedal
- World standard electrical/hydraulic components (parts stocked by JMT or available off-the-shelf from your local supplier)
- Swing-up back gauge

JMT SBT SHEAR OPTIONAL EQUIPMENT

- High speed (strokes per minute)
- Motorized blade gap adjustment
- Laser cutting line
- Light curtains for finger protection
- Pneumatic sheet support device "standard" (JMT I)
- Hydraulic anti-twist device
- Special throat depth
- 49" back gauge
- Additional support arms
- Special blades
- Oil coolant
- Central lubrication manual
- Central lubrication motorized
- Adjustable Angle stop 0-180°
- Special color
- Control panel on opposite position
- Temperature measurement

Many options and customizations are available — please contact us for details.

Web: **JMTUSA.com**

Email: **JMT@JMTUSA.com**

Call Toll Free: **855-773-7727**
(855-PRESS-BRAKE)

JMT SBT SHEAR TECHNICAL DIMENSIONS

SBT SERIES	3006	3010	3013	3016	3020	4006	4013
Cutting Length [A]	10'2"	10'2"	10'2"	10'2"	10'2"	13'4"	13'4"
Cutting Capacity: Mild Steel	.250"	.375"	.500"	.625"	.750"	.250"	.500"
Cutting Capacity: High Tensile (105,000 PSI)	.157"	.250"	.314"	.375"	.500"	.157"	.314"
Throat Depth [D]	2"	2"	2"	13.8"	13.8"	2"	13.8"
Strokes per Minute (Full Length, Max. Capacity)	17 SPM	15 SPM	15 SPM	11 SPM	7 SPM	13 SPM	9 SPM
SPM: High Speed Option (Full Length, Max. Capacity)	26 SPM	21 SPM	20 SPM	15 SPM	8 SPM	25 SPM	19 SPM
Cutting Angle (Degree)	1.4°	1.5°	1.75°	2°	2°	1.5°	1.75°
Rake Angle (per Foot)	1/4"	5/16"	3/8"	7/16"	7/16"	5/16"	3/8"
Holddowns	16	16	16	14	14	20	18
Holddown Force	15 Tons	24 Tons	41 Tons	67 Tons	85 Tons	19 Tons	68 Tons
Back Gauge Range	39.4"	39.4"	39.4"	39.4"	39.4"	39.4"	39.4"
Back Gauge Speed	472 ipm	472 ipm	472 ipm	472 ipm	472 ipm	472 ipm	472 ipm
Motor Power	20 HP	30 HP	40 HP	50 HP	60 HP	20 HP	40 HP
Oil Capacity (U.S. Gallons)	53 Gal.	53 Gal.	87 Gal	108 Gal.	119 Gal.	53 Gal.	87 Gal.
Standard Squaring Arm	59"	59"	59"	59"	59"	59"	59"
Front Sheet Supports	2	2	2	2	2	3	3
Table Height [C]	34"	34"	34"	33"	35"	34"	33"
Table Width [B]	19.7"	22.8"	23.6"	21.7"	22.4"	22.8"	21.7"
Table Length [R]	138.4"	138.4"	139.8"	140.9"	144.5"	177.6"	178.0"
Length [L]	161.8"	165.4"	168.5"	179.1"	175.2"	205.9"	210.6"
Width [W1]	86.6"	86.6"	90.6"	88.6"	89.0"	90.6"	88.6"
Total Width (with Squaring Arm) [W]	145.7"	141.7"	141.7"	150.6"	133.9"	141.7"	151.6"
Height [H]	82.7"	82.7"	92.5"	88.6"	96.5"	84.6"	88.6"
Weight (Lbs.)	17,400	21,300	28,400	36,000	47,845	25,905	35,940

The above are standard specifications.* Please contact us for other sizes and options.

**Due to ongoing product development, specifications are subject to change.*

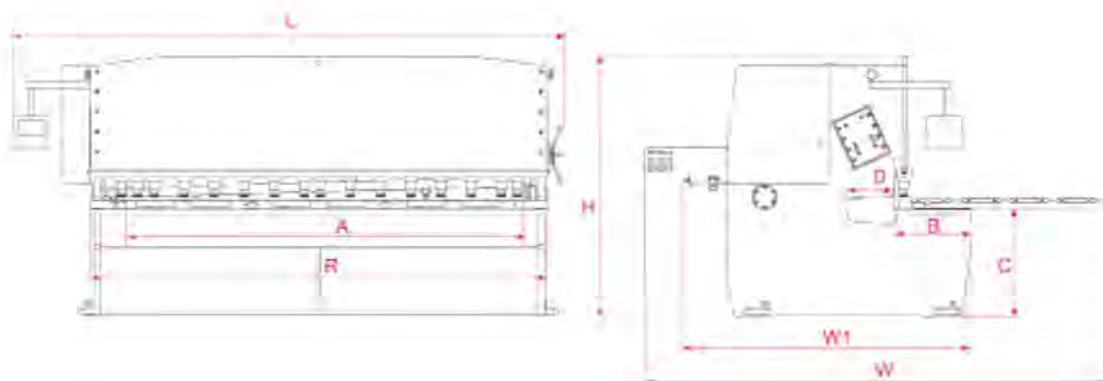

***JMT* MS SERIES SHEAR**

Power Operated Shear

- **12 Gauge – 10 Gauge Capacities**
- **4' – 10' Lengths**
- All-in: Hi-Speed, Accurate, Efficient, Performance
- High performance motor-driven shear
- Direct drive technology provides efficient operations
- Speedy cutting without sacrifice from the cutting quality
- Productive solution for serial production
- Proven quality gear system and mechanical parts
- **Table Top Ball Transfers**

The MS series is equipped with ball transfers in the table. This assists in feeding the sheet as well as reducing marking on sensitive materials.

- **Sheet Hold Downs**

A simple spring style hold down system securely holds the material in place during the shearing process.

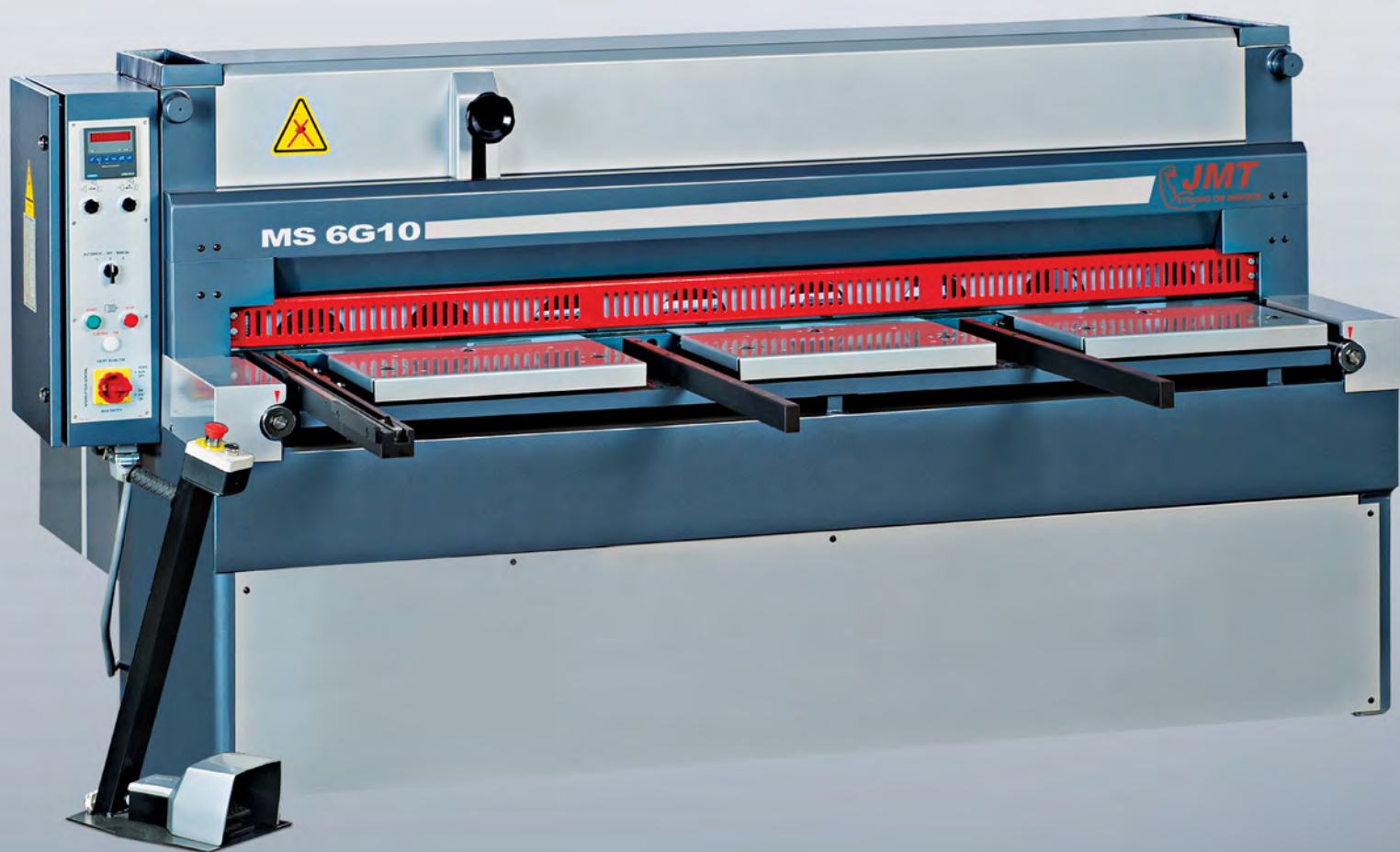

JMT MS SERIES SHEAR FEATURES



Thin Sheet Support System (Optional)

When shearing long drop pieces of thin material the sheet can droop before it reaches the gauge bar, therefore making it impossible to gauge or, at least gauge accurately. In this system support arms that are pneumatically activated support the sheet while gauging and then automatically move away for shearing after the sheet is securely clamped and gauged. This also eliminates the need to front gauge and the need for the operator or additional personnel, to manually support the sheet from the rear side of the machine, which is not only costly, but unsafe.



D-Touch 7 (Optional)

Large Color Touch Screen, Lcd: 7", 800 x 480 Tft Lcd Display
Rapid data input
Easy communication, USB Port: Usb port for user usb flash memory
Ethernet: RJ-45 10/100M
Operating System: Windows CE
User Program and Steps: Unlimited
Material Type: Unlimited

JMT MS SHEAR TECHNICAL DIMENSIONS

MS SERIES	1303	2003	2004	2525	2504	3004
Cutting Capacity	1/8"	1/8"	10 Ga.	12 Ga.	10 Ga.	10 Ga.
Cutting Length	4'5"	6'8"	6'8"	8'4"	8'4"	10'
Cutting Angle	2°	2°	1.5°	1.5°	1.5°	1.5°
Rake Angle (per Foot)	7/16"	7/16"	5/16"	5/16"	5/16"	5/16"
Strokes per Minute	35	35	42	35	42	42
Motor Power 3PH	3	3	7.5	3	7.5	7.5
Back Gauge Range	22"	22"	30"	22"	30"	30"
Table Width	15.75"	15.75"	17.71"	15.71"	17.71"	17.71"
Table Height	33"	33"	32"	33"	32"	32"
Height	48"	48"	53"	48"	53"	53"
Width	53"	53"	90"	53"	90"	90"
Length	67"	95"	100"	112"	120"	144"
Weight Lbs. (Approx.)	2,550	2,900	6,200	3,100	7,250	8,300

The above are standard specifications.* Please contact us for other sizes and options.
Listed specifications represent 60,000 PSI Tensile.

**Due to ongoing product development, specifications are subject to change.*

JMT MS SHEAR STANDARD EQUIPMENT

- High-yield, heavy duty steel construction (St 44) and stress-relieved frame
- Easy blade gap adjustment
- Manual back gauge on models MS 1303, MS 2003, MS 2525
- Ball screw motorized back gauge on models MS 2004, MS 2504, MS 3004
- Ball integrated front tables on MS 2004, MS 2504, MS 3004
- Finger protect
- Portable foot control with emergency stop button
- Top blades with 2 sides, bottom blades with 2 sides on models MS 1303, MS 2003, MS 2525
- Top blades with 2 sides, bottom blades with 4 sides on models MS 2004, MS 2504, MS 3004
- World standard electrical/mechanical components (parts stocked by JMT or available off-the-shelf from your local supplier)

Many options and customizations are available — please contact us for details.

JMT MS SHEAR OPTIONAL EQUIPMENT

- User-friendly CNC Touchscreen control unit (D-Touch 7)
- Illumination and shadow line on MS 2004, MS 2504, MS 3004
- Ball screw motorized back gauge (MS 1303, MS 2003, MS 2525)
- Special back gauge
- Pneumatic thin sheet support system
- Sheet support device with conveyor belt and scrap container
- Stacker + alignment cylinder
- Adjustable angle stop 0-180°
- Additional support arms
- Special blades
- Hold down with rubber
- Special color

Web: **JMTUSA.com**

Email: **JMT@JMTUSA.com**

Call Toll Free: **855-773-7727**
 (855-PRESS-BRAKE)

JMT HELPS YOU DO MORE WITH METAL

CUT IT



BEND IT



ROLL IT



FABRICATE IT



JMTUSA.com

Email: **JMT@JMTUSA.com**

Toll Free: **855-773-7727**
(855-PRESS-BRAKE)

6/2016